

SHIRE OF WANDERING

22 Watts Street, Wandering WA 6308

Ph: (08) 6828 1800

www.wandering.wa.gov.au



Our Vision:

Wandering is a community of responsible, resilient and adaptable residents thriving in our scenic, economically diverse environment.

Wandering Community Centre Upgrade Committee Meeting

Agenda 20 March 2024

The next Wandering Community Centre Committee Meeting of the Shire of Wandering will be held on Wednesday 20 March 2024 in the Council Chambers, 22 Watts Street, Wandering, commencing at 7pm.

**ALAN HART
CHIEF EXECUTIVE OFFICER**

SHIRE OF WANDERING

Agenda for the Wandering Community Centre Meeting to be held in the Council Chambers on Wednesday 20 March 2024 commencing at 7pm.

Contents

1.	Declaration of Opening / Announcements of Visitors	3
2..	Attendance / Apologies / Approved Leave of Absence.....	3
3.	Confirmation of Minutes of Previous Meetings Held.....	4
3.1	Committee Meeting Minutes – 14 February 2024	4
4.	General Business	5
4.1	Project Manager Update Report.....	5
5.	Closure of Meeting	6

1. Declaration of Opening / Announcements of Visitors

The Chairman to declare the meeting open.

2.. Attendance / Apologies / Approved Leave of Absence

Councillors

Cr Max Watts, Cr Sheryl Little, Cr Gillian Hansen

Community Members

Lee Muller, Brendan Whitely

Shire of Wandering Staff

Alan Hart – Chief Executive Officer

Karl Mickle – Operations Manager

Project Manager

Lou Cowan

Apologies

Darralyn Ebsary

3. Confirmation of Minutes of Previous Meetings Held

3.1 Committee Meeting Minutes – 14 February 2024

Statutory Environment:

Section 5.22 of the *Local Government Act* provides that minutes of all meeting to be kept and submitted to the next ordinary meeting of the Council or the committee, as the case requires, for confirmation.

Voting Requirements:

Simple Majority

Recommendation:

That the Minutes of the Wandering Community Centre Upgrade Committee Meeting held on 14 February 2024 be confirmed as true and correct.

Moved: _____

Seconded: _____

Carried

For / Against: L Muller, B Whitely, Cr S Little, Cr M Watts, Cr G Hansen, D Ebsary

4. General Business

4.1 Project Manager Update Report	
File Reference:	11.111.11101
Location:	Down Street, Wandering
Applicant:	N/A
Author:	Lou Cowan, Project Manager
Authorising Officer	Alan Hart, Chief Executive Officer
Date:	13 March 2024
Disclosure of Interest:	Nil
Attachments:	Project Manager Update Report
Previous Reference:	N/A

Summary:

For the Committee to receive the Project Manager’s report.

Background:

The Wandering Community Centre is the hub for the Wandering community and has been identified as a building that needs to be upgraded to ensure that community expectations of a modern facility are addressed and the building is fit for purpose going into the future.

Comment:

The Project Manager will present the report to the Committee at the meeting.

Consultation:

Not applicable

Statutory Environment:

Not applicable

Policy Implications:

Not applicable

Financial Implications:

Nil.

Strategic Implications:

PROVIDE STRONG LEADERSHIP

Our Goals	Our Strategies
A well informed Community	Foster Opportunities for connectivity between Council and the Community
We plan for the future and are strategically focused	Ensure accountable, ethical and best practice governance

Sustainability Implications:

- Environmental: There are no known significant environmental considerations.
- Economic: There are no known significant economic considerations.
- Social: There are no known significant social considerations

Risk Implications:

Nil

Voting Requirements:

Simple Majority

Officer Recommendation:

That the Committee;

1. **Accepts the Project Manager’s report.**
2. **Recommends to Council to accept the quotation from _____ for the supply and installation of the commercial dishwasher at an estimated cost of \$ _____**
3. **Recommends to Council to accept the quotation from _____ for the supply and installation of the Gas Ovens at an estimated cost of \$ _____**
4. **Recommends to Council to accept the quotation from _____ for the supply of the Fridges at an estimated cost of \$ _____**
5. **Recommends to Council to accept the quotation from _____ for the supply and installation of skylights at an estimated cost of \$ _____**
6. **Recommends to Council to accept the quotation from _____ for the supply and installation of glasswasher at an estimated cost of \$ _____**

Moved: _____

Seconded: _____

Carried

For / Against: L Muller, B Whitely, Cr S Little, Cr M Watts, Cr G Hansen, D Ebsary

5. Closure of Meeting

REPORT to UPGRADE COMMITTEE
13 March 2024

Since the last Project Manager report, the following items have taken place and are presented to the Community Centre Upgrade Committee:

Building Design.

- The preliminary dimensioned drawings for the kitchen and store/bar areas are now completed, and attached. Lynette has indicated that she is happy, and commented that it is a big kitchen.
- I have emailed Kim Harris of Harris Design and provided him the required layout dimensions. I have followed up the email with a phone call, but so far with no reply.
- A look in the ceiling void shows that the existing south wall of the kitchen is not a load-bearing wall, however there are steel support columns within the brick wall on each end, with two more partway along, supporting the heavy steel beams running to the verandah posts. This may or may not require the inclusion of a replacement support beam in the roof.

Quotations for Skylights. Quotes have been requested from the following for the supply and installation of four skylights:

1. Bluesky WA. No response.
2. Skylights WA. No quotation yet received.
3. Carter Roofing. Supply and install 4 x high performance double glazed Velux skylights 550mm x 980mm - \$4,062.41
4. Clearview Skylights. Supply and install 4 x manual opening Velux skylights 550mm x 1400mm - \$13,847.27. 4 x remote controlled blackout blinds \$1,259.09 additional.

Now that the kitchen has been dimensioned, it looks like there may be room for 3 skylights in the kitchen, making 5 in total.

Quotations for Stainless Steel Benches.

Pre-pricing of the kitchen benches has been requested from the following, based on the dimensioned drawings:

1. CCR Commercial. Very interested in pricing, and is estimating now.
2. Metro Steel Services. Provided a price previously, and has been requested to confirm price.

Lynette Johnson has suggested that as the kitchen upgrade is progressing well, there is probably not much more that she can offer. She is however available for further discussion if we need her input

Regards – Lou Cowan

Project Manager, Wandering Community Centre Upgrade Project.

**WANDERING COMMUNITY CENTRE UPGRADE
SCHEDULE OF STAINLESS-STEEL BENCHES**

Kitchen Area

Perimeter benches:

1. 1800L x 600D x 900H / shelf under / 100H splashbacks
2. 3400L x 600D x 900H / shelf under / 100H splashbacks / 1420 level servery through wall
3. 3400L x 600D x 900H / shelf under / 100H splashbacks / 1420 level servery through wall
4. 3400L x 550D x 900H / shelf under / 100H splashbacks / 1715 level servery through wall
5. 1200L x 700D x 900H / shelf under / 100H splashbacks
6. 600L x 700D x 900H / shelf under / 100H splashbacks
7. 2100L x 700D x 950H / shelf under / 100H splashbacks / set down to entire bench / double sinks 450 x 450 x 300D
8. 600L x 700D x 900H / shelf under / 100H splashbacks / set down to entire bench
9. 600L x 700D x 900H / shelf under / 100H splashbacks / set down to entire bench

Island Benches:

1. 1500L x 550D x 900H / shelf under / on casters
2. 1500L x 550D x 900H / shelf under / on casters
3. 2650L x 1100D x 900H / shelf under / on casters

Exhaust canopy:

1. Suitable exhaust canopy over ovens

Bar / Storeroom Area

Perimeter benches:

1. 3400L x 600D x 900H / shelf under / 100H splashbacks / 1415 level servery through wall
2. 2700L x 600D x 900H / shelf under / 100H splashbacks / provision for under-counter glass washer / single sinks 450 x 450 x 300D

ALL PRICES ARE EXCLUDING GST	ARCUS	CATERLINK	REWARD	PRACTICAL PRODUCTS	Notes:
Blue Seal Evolution G56D-NG gas cooktop/gas convection oven	\$11,579.00	\$10,759.24			
Waldorf 800 RN8610GC-NG cooktop/gas convection oven	\$12,149.00	\$11,653.58	\$10,780.00		
K+ Series KOV-SB6 gas cooktop/gas oven				\$7,949.00	
Skope BME1200N-A 1079Lt 1280/1180 wide 2 Glass Door White Vertical Fridge		\$4,390.00			Best size at 1079 lt
Skope BME1500N-A 1433Lt 1640/1540 wide 3 Glass Door White Vertical Fridge		\$6,975.27			Too wide
Skope TCE1000N 896Lt 1130/1030 wide 2 Glass Door White Vertical Fridge				\$2,780.00	Small size
Skope TME1000N-A 897Lt 1130/1030 wide 2 Glass Door White Vertical Fridge				\$4,050.00	Small size
Bromic GM1100B-NR 1126Lt 1200/1090 wide 2 Glass Door Black Vertical Fridge		\$4,444.00			Medium size
Bromic GD1000LF 976Lt 1260/1143 wide 2 Glass Door White Vertical Fridge			\$4,050.00		Good size
Meiko Upster 500x500 (rack size) Pass Through Dishwasher		\$5,525.00			
Hobart Ecomax Plus H615 500x500 (rack size) Pass Through Dishwasher			\$6,640.00		
Moffat Washtec XP 500wide (rack size) Pass Through Dishwasher				\$6,013.00	
Hobart Ecomax 604 500x500 (rack size) Pass Through Dishwasher				\$6,613.00	
Meiko Upster 400x400 (rack size) Undercounter Glass Washer		\$2,890.00			
Hobart Ecomax 404 431x355 (rack size) Undercounter Glass Washer			\$3,120.00		
Moffat Washtec XG 435x363 (rack size) Under Counter Glass Washer				\$3,056.00	
Hobart Ecomax 404 431x355 (rack size) Undercounter Glass Washer				\$3,095.00	
Requirement Value:		\$40,502.16	\$39,420.00	\$33,706.00	

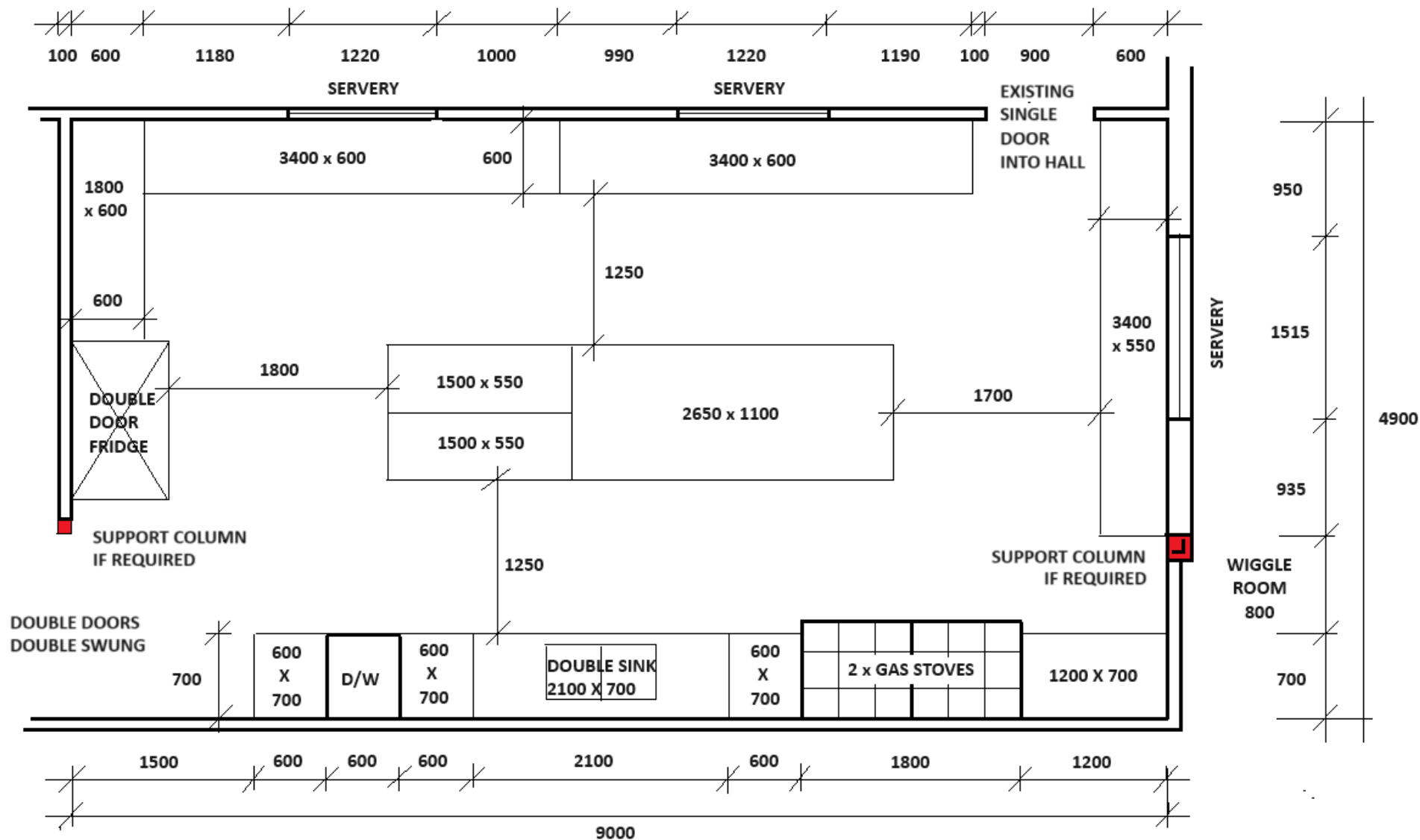

NOTE FOR STAINLESS STEEL BENCHES:

ALL PERIMETER BENCHES TO HAVE 100MM SPLASHBACKS

ISLAND BENCHES TO HAVE PUSH-IN CASTERS

SERVERY SIZE IS SHOWN AS WALL OPENING SIZE. PLEASE ALLOW AN ADDITIONAL 100MM ON EACH SIDE IN THE UPSTANDS AT SERVERY OPENINGS

WANDERING COMMUNITY CENTRE - KITCHEN AREA

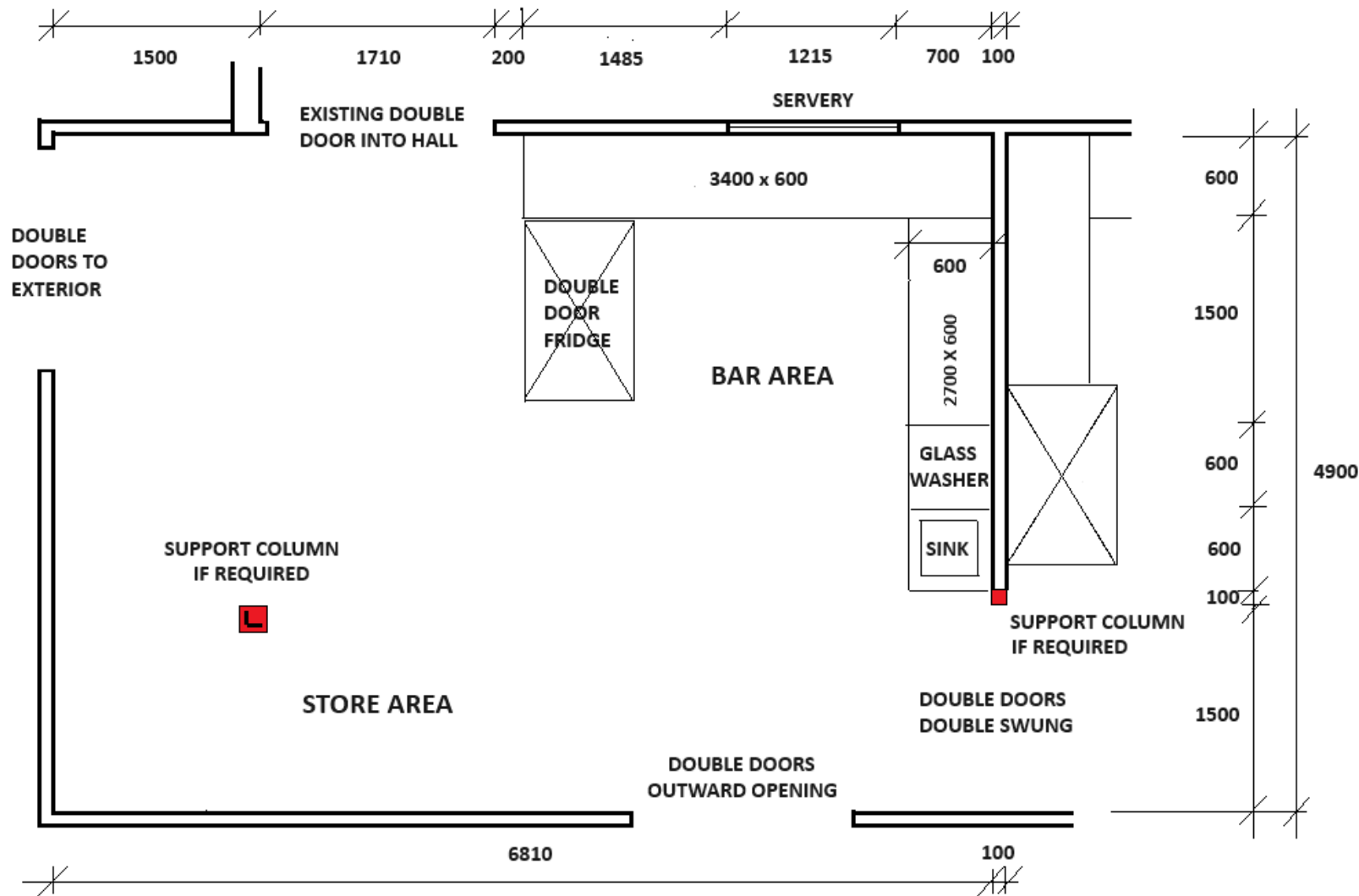

WANDERING COMMUNITY CENTRE - STOREROOM AND BAR AREA

NOTE FOR STAINLESS STEEL BENCHES:

ALL PERIMETER BENCHES TO HAVE 100MM SPLASHBACKS

ISLAND BENCHES TO HAVE PUSH-IN CASTERS

SERVERY SIZE IS SHOWN AS WALL OPENING SIZE. PLEASE ALLOW AN ADDITIONAL 100MM ON EACH SIDE IN THE UPSTANDS AT SERVERY OPENINGS

**Shire of Wandering
Wandering Community Centre Upgrade
for the month Ended
31/03/2024**

Prog	COA	Description	Job	Description	IE	IE	Inc/Exp Analysis	Original Budget	LTD Actual
Life to date Expenditure									
11	E11383	Community Centre Bui WCC232		Wandering Community Centre Construction - Access Ramp to Oval Grant 50	500		Salaries & Wages	\$813.00	\$12,363.94
11	E11383	Community Centre Bui WCC232		Wandering Community Centre Construction - Access Ramp to Oval Grant 52	520		Materials	\$800.00	\$18,895.00
11	E11383	Community Centre Bui WCC232		Wandering Community Centre Construction - Access Ramp to Oval Grant 52	521		Service Contracts/Consultants	\$37,556.00	\$98.18
11	E11383	Community Centre Bui WCC232		Wandering Community Centre Construction - Access Ramp to Oval Grant 90	900		Labour Overheads	\$831.00	\$12,363.83
11	E11383	Community Centre Bui WCC232		Wandering Community Centre Construction - Access Ramp to Oval Grant 90A	901		Plant Operation Costs Recovery	\$0.00	\$1,040.00
				<i>Sub-Total</i>				<u>\$40,000.00</u>	<u>\$44,760.95</u>
11	E11383	Community Centre Bui WCC233		Wandering Community Centre Construction - New Veranda Grant Funde 50	500		Salaries & Wages	\$0.00	\$0.00
11	E11383	Community Centre Bui WCC233		Wandering Community Centre Construction - New Veranda Grant Funde 52	520		Materials	\$0.00	\$7,266.57
11	E11383	Community Centre Bui WCC233		Wandering Community Centre Construction - New Veranda Grant Funde 52	521		Service Contracts/Consultants	\$150,000.00	\$118,054.54
11	E11383	Community Centre Bui WCC233		Wandering Community Centre Construction - New Veranda Grant Funde 90	900		Labour Overheads	\$0.00	\$272.73
11	E11383	Community Centre Bui WCC233		Wandering Community Centre Construction - New Veranda Grant Funde 90A	901		Plant Operation Costs Recovery	\$0.00	\$0.00
				<i>Sub-Total</i>				<u>\$150,000.00</u>	<u>\$125,593.84</u>
11	E11383	Community Centre Bui WCC234		Wandering Community Centre Upgrade - Ktichen Upgrade Grant Funded 50	500		Salaries & Wages	\$0.00	\$0.00
11	E11383	Community Centre Bui WCC234		Wandering Community Centre Upgrade - Ktichen Upgrade Grant Funded 52	520		Materials	\$0.00	\$27,965.28
11	E11383	Community Centre Bui WCC234		Wandering Community Centre Upgrade - Ktichen Upgrade Grant Funded 52	521		Service Contracts/Consultants	\$340,380.00	\$3,954.51
11	E11383	Community Centre Bui WCC234		Wandering Community Centre Upgrade - Ktichen Upgrade Grant Funded 90	900		Labour Overheads	\$0.00	\$0.00
11	E11383	Community Centre Bui WCC234		Wandering Community Centre Upgrade - Ktichen Upgrade Grant Funded 90A	901		Plant Operation Costs Recovery	\$0.00	\$0.00
				<i>Sub-Total</i>				<u>\$340,380.00</u>	<u>\$31,919.79</u>
TOTAL WANDERING COMMUNITY CENTRE UPGRADE								<u>\$530,380.00</u>	<u>\$202,274.58</u>
Funding Sources									
		LRCI Phase 3		Funding to be spent by 30/06/24				\$365,380.00	\$163,105.42
		LRCI Phase 4		Funding to be spent by 30/06/25				\$182,000.00	\$182,000.00
TOTAL FUNDING SOURCES								<u>\$547,380.00</u>	<u>\$345,105.42</u>